

# THE WESTMINSTER KENNEL CLUB

---

(Member of the American Kennel Club)

## JUDGING PROGRAM 2021

145th ANNUAL DOG SHOW & 6th ANNUAL  
MASTERS OBEDIENCE CHAMPIONSHIP

- UNBENCHED -

Event No. 2021123701

All judging will be outdoors

SATURDAY and SUNDAY

JUNE 12th and 13th, 2021

Show Hours: 7:00 A.M. to 11:30 P.M. (E.D.T.) Each Day

**LYNDHURST**  
**635 South Broadway**  
**Tarrytown, NY 10591**

---

### **NOTE:**

**For COVID-19 protocols and procedures  
for admission into the site, please go to  
[reelhealth.com/WKC](http://reelhealth.com/WKC)**

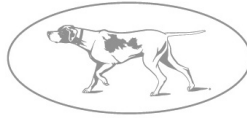

THE 145<sup>TH</sup> ANNUAL

# WESTMINSTER KENNEL CLUB DOG SHOW

PRESENTED BY



Welcome to the 145<sup>th</sup> Annual Westminster Kennel Club Dog Show. We are pleased to share this premier dog show experience across a variety of platforms, from live television to live streaming and social media. Watch with us as we witness thousands of top dogs and canine athletes from around the world compete in breed, agility, and obedience events, all from the beautiful Lyndhurst Estate in Tarrytown, New York.

This annual showcase of canine companionship and promotion of responsible dog ownership is not to be missed, as we celebrate the purpose-bred dog and honor dedicated breed preservation.

Our gratitude goes out to the breeders, exhibitors, and sponsors for their continued support of this iconic event, and to Fox Sports for bringing the excitement of dog sports live to a worldwide audience of dog lovers.

Charlton Reynders, III  
*President*

David W. Haddock & David A. Helming  
*Chairmen*

*The Westminster Kennel Club Dog Show*

# TABLE OF CONTENTS

- COVID-19 Protocol..... Page 4
  - Notices ..... Page 5
  - Hotels..... Page 6
  - For the Dogs..... Page 7  
(Veterinary Service, Show Photographers)
  - Telecast Notice ..... Page 8
  - Entry Procedure ..... Page 9
  - Show Logistics..... Page 9
  - Judging Schedule..... Page 10
    - Saturday..... Page 10
    - Sunday ..... Page 20
  - Rules and Procedures ..... Page 28
  - Parking ..... Page 28
  - Driving Directions ..... Page 33
  - Grounds Layout ..... Pages 34-35
- 

## MISCONDUCT

In order to expedite the Event Committee's handling of Incidents or Charges of Conduct Prejudicial to the Sport, the Committee requests, if possible, that charges be received in writing at the Show site within one hour of the incident so they may fully investigate & hear testimony and resolve the same day to the extent possible.

---

## ABSENTEES

Please notify MB-F, Inc. immediately if your dog will be absent. See Separate Notice on dog ID Ticket.

---

## NOTE

**NO CONFORMATION, OBEDIENCE OR JUNIOR DOGS WILL BE ADMITTED INTO THE GROUNDS PRIOR TO 6:00 A.M. Saturday, June 12, 2021.**

EQUIPMENT & SERVICE FURNISHED BY:  **MB-F<sup>®</sup> Inc.**

*"Please feel free to come by and take a tour of our Headquarters Office in NC any business day Mon. thru Fri., 9:00 A.M. to 4:00 P.M."*

MB-F  
SHOW  
# 491

620 Industrial Ave. • P.O. Box 22107 • Greensboro, NC 27420 • 336-379-9352  
32351 Edward Ave. • P.O. Box 9999 • Madison Hts., MI 48071 • 248-588-5000  
FAX - 336-272-0864 • Internet Address <http://www.infodog.com>  
E-Mail Address [mbf@infodog.com](mailto:mbf@infodog.com)

AMERICAN KENNEL CLUB ANNUALLY LICENSED SUPERINTENDENT  
Member of the Dog Show Superintendents Association • [dogshowsupers.org](http://dogshowsupers.org)

---

# COVID-19 PROTOCOL

The safety and security of all exhibitors, Judges and attendees at the show is paramount to The Westminster Kennel Club (WKC). Every effort will be made to maintain proper protocols at the event.

WKC has followed NY State Covid-19 Guidelines and Requirements & AKC Best Practices. Lyndhurst's own protocols will also be in effect during the show. These resources were used in developing an extensive show Covid Compliance Plan which has been approved by the NY State and Westchester County Departments of Health. The Westminster Kennel Club has engaged Reel Health, a health and safety firm, to administer this plan and to provide Covid-19 prevention services for the events.

For entry to the Lyndhurst grounds, all attendees must:

1. Provide proof of Covid-19 vaccination  
Or
2. Have a Negative Covid-19 PCR test performed by either one of the four approved national health providers (Curative, CVS, Rite Aid, Walgreens) or by Reel Health within 72 hours prior to their first entry time for these events.

You must either record proof of Covid-19 vaccination or results of your Covid-19 PCR test from either Curative, CVS, Rite Aid, Walgreens or Reel Health when registering on the Reel Health website.

At the show, requirements will include:

- Mandatory face masks or coverings ("PPE")
- Daily Temperature Checks
- 6 - feet social distancing rules
- Signed waivers when registering with Reel Health to be on the show grounds
- Special access wristbands

For the latest NY State Covid-19 updates:

**<https://coronavirus.health.ny.gov/home>**

---

---

***By entering, exhibiting and attending this show, all parties associated with the entry acknowledge, accept and agree to comply at all times with all of the COVID-19 compliance requirements described herein, or as otherwise amended prior to or during the event. Requirements may be updated by NY State as restrictions and guidelines continue to evolve. You further agree to release The Westminster Kennel Club, Lyndhurst Estate, MB-F, and AKC of any liability relating to COVID-19, as all AKC, Lyndhurst, CDC, State, local and County policies will be strictly enforced.***

# FIRST AID/COVID SAFETY

The Tarrytown Ambulance Corp., will be on site throughout the show with an ambulance and two EMT's. They will be equipped with an AED.

Reel Health, On-Set Health & Safety will be on site to administer COVID-19 safety and protocol compliance.

---

## RELEASE PROTOCOL

Due to **COVID-19** guidelines we request all follow a "*Show and Go*" protocol each day. Thank you.

---

## PROMOTIONAL RIGHTS

All rights to TELEVISION, VIDEO TAPE, ADVERTISE, PHOTOGRAPH, PROMOTE or otherwise share this event are vested in THE WESTMINSTER KENNEL CLUB, or in persons to whom assignments of such rights have been made in writing by the Club. All persons and animals on the showgrounds at any time while the show is in progress, do by attending this show or participating therein, grant to the Club and its partners the right to photograph, televise, videotape, audiotape or otherwise use their likeness and voice in any manner without further release or consent.

---

## VENDORS

The Kennel Club and its officials are not responsible for the actions or products of the commercial vendors at this show.

---

## AWARDS OF MERIT

Following the choice of Best of Breed and Selects, the judges **MAY** at their discretion, select Award of Merit winners **from the remaining entrants**. The number of awards that may be made is determined by the size of the entry:

- 2-10 entries - 1 Award of Merit
- 11-20 entries - 2 Awards of Merit
- 21-30 entries - 3 Awards of Merit
- 31-40 entries - 4 Awards of Merit
- 41 + entries - 5 Awards of Merit

## VETERINARIAN'S RECOMMENDATION

*“Exhibitors should follow their veterinarian's recommendation to assure their dogs are free of internal and external parasites, any communicable diseases, and have appropriate vaccinations.”* This would include up-to-date rabies shot.

---

## STATE LAWS

The New York State Health Code requires all animals to be accompanied by a Current Rabies Vaccination Certificate issued by a licensed Veterinarian.

---

## NOTE:

To find out about any AKC event cancellations call the AKC Event Cancellation Hotline (877) 252-3229.

---

## GROUP HOTEL INFORMATION

The Westminster Kennel Club has arranged for accommodations at a number of hotels in the area for our shows. Check [www.westminsterkennelclub.org](http://www.westminsterkennelclub.org) for the latest hotel information.



THE 145<sup>TH</sup> ANNUAL

WESTMINSTER  
KENNEL CLUB DOG SHOW

PRESENTED BY



[westminsterkennelclub.org](http://westminsterkennelclub.org)

## **FOR THE DOGS**

### **VETERINARY SERVICE IN ATTENDANCE**

Cornell University College of Veterinary Medicine  
Ithaca, NY 14853-6401 ([www.vet.cornell.edu](http://www.vet.cornell.edu))  
Cornell University Veterinary Specialists  
880 Canal St., Stamford, CT 06902 ([www.cuvs.org](http://www.cuvs.org))

### **VETERINARY CARE**

#### **24 HOUR EMERGENCY SERVICES**

**Cornell University Veterinary Specialists**, 880 Canal St., Stamford, CT 06902. <https://www.vet.cornell.edu/covid-19/clients-and-veterinarians#top>

E-mail: [info@cuvs.org](mailto:info@cuvs.org) (203) 595-2777 Distance from Lyndhurst to CUVS - 24.8 miles/approx. 30 minute car ride.

**Veterinary Emergency Group**, 201 Tarrytown Rd., White Plains, NY 10607 (914) 949-8779 Distance from Lyndhurst to VEG - 5.3 miles/approx. 12 minute car ride.

**Oradell Animal Hospital**, 580 Winters Ave., Paramus, NJ 07652 [www.oradell.com](http://www.oradell.com) (201) 262-0010 Distance from Lyndhurst to Oradell - 13.2 miles, 28 minute car ride.

### **OFFICIAL PHOTOGRAPHERS**

- John & Andrea Ashbey, P.O. Box 468, Gilbert, PA 18331 (610) 681-4968
- Fritz Clark, P.O. Box 74, Gilsun, NH 03448 (603) 357-7086
- J.C. Photography, P.O. Box 7309, N. Arlington, NJ 07031 (201) 772-5014  
(Only the Official Photographers may take win pictures.)

---

**IMPORTANT** - TRANSFERS of dogs from regular classes to Best of Breed/Variety Competition (Ch. 11 Section 6, AKC Rules) MUST be made to the Superintendent/Show Secretary at least one half hour prior to the start of any regular conformation judging at this show. TRANSFERS by Junior Handlers from Novice to Open Class or from the Open to Master Class MUST be made to the Superintendent/Show Secretary prior to the judging of the class at the show. SUBSTITUTIONS of Junior Showmanship dogs must be made prior to the judging of the class at the show.

---

**Juniors, who substitute for the original dog they have entered in the Junior Showmanship Class with a dog that is not entered in one of the offered classes at this show, will not incur an additional fee.**

# **TELECAST NOTICE**

FOX will televise daytime breed judging and Jr. Showmanship on FS2 on Saturday and Sunday from 1-4 PM (EDT). The Saturday evening broadcast will begin with a Pre-Show at 7 PM followed by Groups on FS1 from 7:30 - 11 PM (EDT). The Sunday evening broadcast on FOX will begin with a Pre-Show at 7:00 PM (EDT) followed by Groups and BIS from 7:30 - 11:00 PM (EDT).

***A full schedule of all telecast coverage is below:***

## **FRIDAY, JUNE 11, 2021**

### ***Masters Agility Championship Preliminaries***

- 8:00 AM - 4:00 PM **streaming LIVE** on [westminsterkennelclub.org](http://westminsterkennelclub.org)

## **SATURDAY, JUNE 12, 2021**

### ***Masters Agility Championship Finals***

- 5:00 PM - 7:00 PM **telecast on FOX** and streaming for subscribers of the **FOX NOW App** and **FOX Sports App**

### ***Westminster Kennel Club Dog Show***

- 8:00 AM - 4:30 PM Breed Judging, Junior Showmanship Preliminaries **streaming LIVE** on [westminsterkennelclub.org](http://westminsterkennelclub.org).
- Breed judging will also be available as **Videos on Demand** on [westminsterkennelclub.org](http://westminsterkennelclub.org)
- 1:00 PM - 4:00 PM **telecast LIVE** on **FS2 select** coverage of Breed Judging and Junior Showmanship Preliminaries. Will also be **streaming LIVE** for subscribers of the **FOX NOW App** and **FOX Sports App**.
- 7:00 PM - 7:30 PM **telecast LIVE** on **FS1** Pre-Show Programming
- 7:30 PM - 11:00 PM **telecast LIVE** on **FS1** Group Judging (Hound, Toy, Non-Sporting, and Herding Groups). Will also be **streaming LIVE** for subscribers of the **FOX NOW App** and **FOX Sports App**.

## **SUNDAY, JUNE 13, 2021**

### ***Masters Obedience Championship***

- 8:00 AM - 4:30 PM Obedience competition **streaming LIVE** on [westminsterkennelclub.org](http://westminsterkennelclub.org)

### ***Westminster Kennel Club Dog Show***

- 8:00 AM - 4:30 PM Breed Judging, Junior Showmanship Preliminaries **streaming LIVE** on [westminsterkennelclub.org](http://westminsterkennelclub.org).
- Breed judging will also be available as **Videos on Demand** on [westminsterkennelclub.org](http://westminsterkennelclub.org)
- 1:30 PM - 4:00 PM **telecast LIVE** on **FS1 select** coverage of Breed Judging and Junior Showmanship Preliminaries. Will also be **streaming LIVE** for subscribers of the **FOX NOW App** and **FOX Sports App**.
- 7:00 PM - 7:30 PM **telecast LIVE** on **FOX** Pre-Show Programming to include coverage of Junior Showmanship Finals.
- 7:30 PM - 11:00 PM **telecast LIVE** on **FOX** Group Judging (Sporting, Working, Terrier Groups, followed by Best in Show). Will also be **streaming LIVE** for subscribers of the **FOX NOW App** and **FOX Sports App**.



## **Entering The Site**

- Gate will open at 6:00 AM, judging starts at 9:00 AM both days.
- Your exhibitor hangtag must be displayed upon entry.
- Prior to arrival, please ensure you have downloaded the Reel Health App and completed your COVID questionnaire and verification by visiting [\*\*reelhealth.com/wkc\*\*](https://reelhealth.com/wkc)
- In order to expedite entry to the site, please follow the direction of the Tarrytown Village Police, as well as WKC security and Site Control personnel.
- Upon entering the front gate at Lyndhurst, Exhibitors should stay to the left and show your admission ticket(s) and show that you have the Reel Health App loaded on your phone.
- Continue on to the Reel Health COVID check in, where you will have your temperature checked & present your Reel Health App and identification to verify you have been cleared to enter the show site. Reel Health will collect your admission ticket and provide you with a wristband for placement on your left wrist.
- You will then be directed by Site Control to your parking space.

## **Show Logistics**

- As your safety is a top priority, we ask that you wear a mask at all times when on site and maintain social distancing.
- As you could experience delays entering the show grounds due to Covid protocol check in, it is recommended, you arrive on site two hours before your scheduled judging time.
- If your dog is being judged later in the day, please arrive later.

## **Emergency Contacts**

David Helming (212) 213-2542

David Haddock (332) 213-2611

---

---

**SATURDAY, JUNE 12, 2021**

---

---

ENTRY	BREED	RING	TIME
7	Affenpinschers	7	3:15
21	Afghan Hounds	2	11:30
4	American English Coonhounds	3	2:15
10	American Eskimo Dogs	8	1:30
9	American Foxhounds	3	1:15
18	Australian Cattle Dogs	3	9:00
24	Australian Shepherds	5	9:45
4	Azawakhs	1	12:00
17	Basenjis	1	3:30
11	Basset Hounds	1	3:30
9	Beagles, 13 Inch	1	2:15
21	Beagles, 15 Inch	1	1:15
10	Bearded Collies	5	11:45
10	Beaucerons	4	9:00
6	Belgian Laekenois	4	2:30
12	Belgian Malinois	4	12:30
11	Belgian Sheepdogs	4	12:30
22	Belgian Tervuren	4	1:30
11	Bergamasco Sheepdogs	4	10:00
16	Berger Picards	4	11:00
14	Bichons Frises	6	10:30
10	Biewer Terriers	8	10:15
8	Black and Tan Coonhounds	3	1:15
6	Bloodhounds	3	1:15
7	Bluetick Coonhounds	3	3:15
14	Border Collies	5	11:45
15	Borzoi	1	12:00
21	Boston Terriers	5	2:15
6	Bouvier des Flandres	3	11:00
10	Briards	4	10:00
16	Brussels Griffons	7	10:00
18	Bulldogs	5	9:00
7	Canaan Dogs	4	11:00
17	Cardigan Welsh Corgis	4	2:30
33	Cavalier King Charles Spaniels	7	1:00
15	Chihuahuas (Long Coat)	8	11:15
14	Chihuahuas (Smooth Coat)	8	10:15
20	Chinese Cresteds	7	12:00
8	Chinese Shar-Pei	8	1:30
8	Chow Chows	6	10:30
14	Cirnechi dell'Etna	3	2:15
9	Collies (Rough)	3	11:00
11	Collies (Smooth)	3	10:00
7	Cotons de Tulear	8	12:30
16	Dachshunds (Longhaired)	2	2:15
19	Dachshunds (Smooth)	2	2:15
17	Dachshunds (Wirehaired)	2	2:15
17	Dalmatians	7	2:15
2	English Foxhounds	3	3:15
2	English Toy Spaniels (B & PC)	7	12:00
8	English Toy Spaniels (KC & R)	6	3:00
2	Entlebucher Mountain Dogs	3	12:00
7	Finnish Lapphunds	3	10:00
3	Finnish Spitz	5	2:15
27	French Bulldogs	6	11:45
16	German Shepherd Dogs	6	2:15
7	Grand Basset Griffon Vendeens	1	2:15
9	Greyhounds	1	9:00
3	Harriers	2	9:00
23	Havanese	7	11:00

ENTRY	BREED	RING	TIME
12	Ibizan Hounds	1	9:00
10	Icelandic Sheepdogs	5	3:15
20	Irish Wolfhounds	2	12:45
25	Italian Greyhounds	7	9:00
13	Japanese Chin	6	3:00
20	Junior Showmanship Competition Prelim. #1	5	1:00
20	Junior Showmanship Competition Prelim #2	6	1:00
9	Keeshonden	8	12:30
8	Lhasa Apsos	7	4:15
4	Lowchen	6	10:30
4	Maltese	7	4:15
8	Manchester Terriers (Toy)	7	10:00
20	Miniature American Shepherds	5	10:45
11	Miniature Pinschers	7	3:15
5	Norwegian Buhunds	5	3:15
6	Norwegian Elkhounds	3	2:15
9	Old English Sheepdogs	5	3:15
8	Otterhounds	3	3:15
15	Papillons	8	2:15
9	Pekingese	8	2:15
22	Pembroke Welsh Corgis	4	3:30
14	Petits Bassets Griffons Vendeens	1	2:15
9	Pharaoh Hounds	1	10:00
7	Plott Hounds	2	9:00
10	Polish Lowland Sheepdogs	4	9:00
13	Pomeranians	8	3:15
8	Poodles (Miniature)	8	4:15
16	Poodles (Standard)	8	4:15
10	Poodles (Toy)	8	3:15
9	Portuguese Podengo Pequenos	2	9:00
32	Pugs	8	9:00
8	Pulik	3	11:00
6	Pumik	3	10:00
10	Pyrenean Shepherds	3	12:00
10	Redbone Coonhounds	3	3:15
30	Rhodesian Ridgebacks	2	9:45
13	Salukis	1	10:00
9	Schipperkes	8	12:30
11	Scottish Deerhounds	2	12:45
8	Shetland Sheepdogs	3	12:00
8	Shiba Inu	6	9:00
8	Shih Tzu	6	3:00
3	Silky Terriers	8	11:15
6	Spanish Water Dogs	3	9:00
3	Swedish Vallhunds	3	12:00
6	Tibetan Spaniels	7	2:15
18	Tibetan Terriers	6	9:45
7	Toy Fox Terriers	7	3:15
9	Treeing Walker Coonhounds	3	3:15
22	Whippets	1	11:00
10	Xoloitzcuintli	6	9:00
10	Yorkshire Terriers	8	11:15

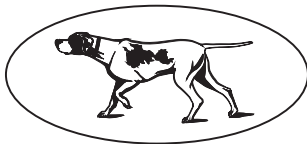

---

---

## PROGRAM OF JUDGING

There are 2587 dogs entered in this show with a total entry of 2624 in 206 different Breeds or Varieties, including 50 obedience entries. For your convenience, the following division of sexes has been carefully tabulated; however, neither the Club nor the Superintendent/Show Secretary assumes responsibility for absolute accuracy.

In accordance with Chapter 7, Section 8, of "Rules Applying to Dog Shows" and with American Kennel Club Approval the following changes apply:

<u>BREED</u>	<u>SATURDAY ORIGINAL JUDGE</u>	<u>NEW JUDGE</u>
American English Coonhounds	Ms. Pamela Bruce	Mr. Randy E. Garren
American Foxhounds	Ms. Pamela Bruce	Mr. Randy E. Garren
Basenjis	Mrs. Robyn Joy Wallis	Ms. Bonnie P. Threlfall
Basset Hounds	Mrs. Robyn Joy Wallis	Ms. Bonnie P. Threlfall
Beagles, 13 In.	Mrs. Robyn Joy Wallis	Ms. Bonnie P. Threlfall
Beagles, 15 In.	Mrs. Robyn Joy Wallis	Ms. Bonnie P. Threlfall
Black and Tan Coonhounds	Ms. Pamela Bruce	Mr. Randy E. Garren
Bloodhounds	Ms. Pamela Bruce	Mr. Randy E. Garren
Bluetick Coonhounds	Ms. Pamela Bruce	Mr. Randy E. Garren
Cirnechi dell 'Etna	Ms. Pamela Bruce	Mr. Randy E. Garren
English Foxhounds	Ms. Pamela Bruce	Mr. Randy E. Garren
Grand Basset Griffon Vendeens	Mrs. Robyn Joy Wallis	Ms. Bonnie P. Threlfall
Norwegian Elkhounds	Ms. Pamela Bruce	Mr. Randy E. Garren
Otterhounds	Ms. Pamela Bruce	Mr. Randy E. Garren
Petits Bassets Griffons Vendeens	Mrs. Robyn Joy Wallis	Ms. Bonnie P. Threlfall
Redbone Coonhounds	Ms. Pamela Bruce	Mr. Randy E. Garren
Treering Walking Coonhounds	Ms. Pamela Bruce	Mr. Randy E. Garren
Boston Terriers	Mr. Carl E. Gomes	Mr. George Miltinovich
Finnish Spitz	Mr. Carl E. Gomes	Mr. George Miltinovich
Non-Sporting Group	Dr. John Reeve-Newson	Mr. Dennis McCoy

<u>BREED</u>	<u>SUNDAY ORIGINAL JUDGE</u>	<u>NEW JUDGE</u>
Pointers (German Shorthaired)	Mrs. Robyn Joy Wallis	Mr. Mark E. Threlfall
Pointers (German Wirehaired)	Mrs. Robyn Joy Wallis	Mr. Mark E. Threlfall
Retrievers (Golden)	Mr. Dan Ericsson	Ms. Marjorie Martorella
Retrievers (Labrador)	Mr. Dan Ericsson	Ms. Marjorie Martorella
Setters (English)	Mrs. Robyn Joy Wallis	Ms. Marjorie Martorella
Setters (Gordon)	Mrs. Robyn Joy Wallis	Mr. Mark E. Threlfall
Setters (Irish)	Mrs. Robyn Joy Wallis	Mr. Mark E. Threlfall
Setters (Irish Red and White)	Mrs. Robyn Joy Wallis	Mr. Mark E. Threlfall
Spaniels (American Water)	Ms. Pamela Bruce	Mr. Michael Faulkner
Spaniels (Boykin)	Ms. Pamela Bruce	Mr. Michael Faulkner
Spaniels (Clumber)	Ms. Pamela Bruce	Mr. Michael Faulkner
Spaniels (Cocker) Black	Ms. Pamela Bruce	Mr. Mark E. Threlfall
Spaniels (Cocker) ASCOB	Ms. Pamela Bruce	Mr. Michael Faulkner
Spaniels (Cocker) Parti	Ms. Pamela Bruce	Mr. Michael Faulkner
Spaniels (English Cocker)	Ms. Pamela Bruce	Ms. Marjorie Martorella
Spaniels (English Springer)	Ms. Pamela Bruce	Mr. Michael Faulkner
Spaniels (Field)	Ms. Pamela Bruce	Mr. Michael Faulkner
Spaniels (Irish Water)	Ms. Pamela Bruce	Mr. Michael Faulkner
Spaniels (Welsh Springer)	Ms. Pamela Bruce	Mr. Michael Faulkner
Spaniels (Sussex)	Ms. Pamela Bruce	Mr. Michael Faulkner
Airedale Terriers	Mr. Dan Ericsson	Ms. Patricia Anne Keenan
American Staffordshire Terriers	Mr. Dan Ericsson	Ms. Patricia Anne Keenan
Bull Terriers (Colored)	Mr. Dan Ericsson	Ms. Patricia Anne Keenan
Bull Terriers (White)	Mr. Dan Ericsson	Ms. Patricia Anne Keenan
Fox Terriers (Smooth)	Mr. Dan Ericsson	Ms. Patricia Anne Keenan
Fox Terriers (Wire)	Mr. Dan Ericsson	Ms. Patricia Anne Keenan
Parson Russell Terriers	Mr. Dan Ericsson	Ms. Patricia Anne Keenan
Rat Terriers	Mr. Dan Ericsson	Ms. Patricia Anne Keenan

**SUNDAY****BREED**

Russell Terriers  
 Scottish Terriers  
 Sealyham Terriers  
 West Highland White Terriers  
 Sporting Group

**ORIGINAL JUDGE**

Mr. Dan Ericsson  
 Mr. Dan Ericsson  
 Mr. Dan Ericsson  
 Mr. Dan Ericsson  
 Mr. Frank Kane

**NEW JUDGE**

Ms. Patricia Anne Keenan  
 Ms. Patricia Anne Keenan  
 Ms. Patricia Anne Keenan  
 Ms. Patricia Anne Keenan  
 Mr. James S. Covey

The number before each Breed (Variety) indicates the number of dogs entered in that Breed (Variety). The numbers following each Breed (Variety) indicate the number of Regular Class Dogs, Regular Class Bitches, Best of Breed (Variety) (Dogs-Bitches), and Non-Regular Class Dogs or Bitches.

**SATURDAY, JUNE 12, 2021****RING ONE****JUDGE: Mr. Harold "Red" Tatro, III**

10301 Brangus Dr. , Crowley, TX 76036

STEWARDS: Mr. Peter Pettersen &amp; Ms. Karen Rockwell

**9:00 AM**

9 Greyhounds 4-5  
 12 Ibizan Hounds 8-4

**10:00 AM**

9 Pharaoh Hounds 4-5  
 13 Salukis 9-4

**11:00 AM**

22 Whippets 13-9

**12:00 NOON**

4 Azawakhs 0-4  
 15 Borzois 9-6

84 Total Dogs

**RING ONE****JUDGE: Ms. Bonnie P. Threlfall**

105 Tayport Ct. , Cary, NC 27511

STEWARDS: Mrs. Ann J. Yuhasz &amp; Mrs. Jan Ritchie Gladstone

**1:15 PM**

21 Beagles, 15 Inch 14-7

**2:15 PM**

7 Grand Basset Griffon Vendeens 4-3  
 9 Beagles, 13 Inch 1-8  
 14 Petits Bassets Griffons Vendeens 7-7

**3:30 PM**

11 Basset Hounds 7-4  
 17 Basenjis 10-7

128 Total Dogs

**RING TWO****JUDGE: Ms. Bonnie P. Threlfall**

105 Tayport Ct. , Cary, NC 27511

**9:00 AM**

STEWARDS: Mrs. Gayle Bontecou &amp; Mrs. Polly Smith

3 Harriers 2-1  
 7 Plott Hounds 4-3  
 9 Portuguese Podengo Pequenos 9-0

**9:45 AM**

30 Rhodesian Ridgebacks 16-14

See Ring 1 at 1:15 PM for balance of assignment.

**RING TWO**

**JUDGE: Mrs. Jan Swayze-Curry**

205 Elbert Frankum Rd., Columbia, KY 42728

**11:30 AM**

STEWARDS: Mrs. Susan Sprung, Ms. Viola Burgos & Ms. Theresa Hundt  
21 Afghan Hounds 12-9

See 2:15 PM for balance of assignment.

**RING TWO**

**JUDGE: Hon. James G. Phinizy**

P.O. Box 175 227 Black North Rd., Acworth, NH 03601

**12:45 PM**

STEWARDS: Mrs. Susan Sprung, Ms. Viola Burgos & Ms. Theresa Hundt  
11 Scottish Deerhounds 5-6  
20 Irish Wolfhounds 11-9  
31 Total Dogs

**RING TWO**

**JUDGE: Mrs. Jan Swayze-Curry**

205 Elbert Frankum Rd., Columbia, KY 42728

**2:15 PM**

STEWARDS: Mrs. Susan Sprung, Ms. Viola Burgos & Ms. Theresa Hundt  
17 Dachshunds (Wirehaired) 7-10  
19 Dachshunds (Smooth) 6-13  
16 Dachshunds (Longhaired) 10-6  
73 Total Dogs

**RING THREE**

**JUDGE: Mr. James J. Mitchell**

119 W. 20th St., Wilmington, DE 19802

**9:00 AM**

STEWARDS: Ms. Debra Gschwender & Mr. Rick Gschwender  
6 Spanish Water Dogs 3-3  
18 Australian Cattle Dogs 10-8

**10:00 AM**

11 Collies (Smooth) 4-7  
7 Finnish Lapphunds 6-1  
6 Pumik 4-2

**11:00 AM**

9 Collies (Rough) 6-3  
6 Bouviers des Flandres 3-3  
8 Pulik 6-2

**12:00 NOON**

3 Swedish Vallhunds 2-1  
2 Entlebucher Mountain Dogs 2-0  
8 Shetland Sheepdogs 5-3  
10 Pyrenean Shepherds 2-8

94 Total Dogs

**RING THREE**

**JUDGE: Mr. Randy E. Garren**

8537 Smith Rd., Apex, NC 27539

**1:15 PM**

STEWARDS: Mr. Eddie Dzuik & Dr. Niska Lemo  
9 American Foxhounds 5-4  
8 Black and Tan Coonhounds 4-4  
6 Bloodhounds 5-1

**2:15 PM**

- 4 American English Coonhounds 2-2
- 6 Norwegian Elkhounds 3-3
- 14 Cirnechi dell'Etna 8-6

**3:15 PM**

- 8 Otterhounds 5-3
- 2 English Foxhounds 1-1
- 9 Treeing Walker Coonhounds 4-5
- 10 Redbone Coonhounds 7-3
- 7 Bluetick Coonhounds 5-2

83 Total Dogs

**RING FOUR**

**JUDGE: Ms. Sheree W. Moses**

P.O. Box 448 , Wardensville, WV 26851

**9:00 AM**

STEWARDS: Mrs. Laura Bedford & Mrs. Sandra McCue

- 10 \*Beaucerons 7-3
- 10 \*Polish Lowland Sheepdogs 6-4

**10:00 AM**

- 11 \*Bergamasco Sheepdogs 5-6
- 10 Briards 7-3

**11:00 AM**

- 7 Canaan Dogs 5-2
- 16 \*Berger Picards 9-7

See Ring 5 at 3:15 PM for balance of assignment.

**RING FOUR**

**JUDGE: Mrs. Sharon Ann Redmer**

7687 Nollar Rd. , Whitmore Lake, MI 48189

**12:30 PM**

STEWARDS: Mr. Michael Canalizo & Mr. Milan Lint

- 12 Belgian Malinois 9-3
- 11 Belgian Sheepdogs 4-7

**1:30 PM**

- 22 Belgian Tervuren 14-8

**2:30 PM**

- 6 Belgian Laekenois 3-3
- 17 Cardigan Welsh Corgis 9-8

**3:30 PM**

- 22 Pembroke Welsh Corgis 14-8

90 Total Dogs

**RING FIVE**

**JUDGE: Mr. David J. Kirkland**

387 Holly Brook Rd. , Sanford, NC 27330

**9:00 AM**

STEWARDS: Ms. Elaine Lessig & Mr. Bryan Martin

- 18 Bulldogs 12-6

**9:45 AM**

- 24 Australian Shepherds 16-8

**10:45 AM**

- 20 Miniature American Shepherds 16-4

See Ring 6 at 11:45 AM for balance of assignment.

**RING FIVE**

**JUDGE: Mr. Johan Becerra-Hernandez**

16 Riverside Blvd. Urb. Carmen Hills, San Juan, PR 00926

**11:45 AM**

STEWARDS: Ms. Elaine Lessig & Mr. Bryan Martin

10 Bearded Collies 5-5

14 Border Collies 8-6

See Ring 6 at 2:15 PM for balance of assignment.

**RING FIVE**

**JUDGE: Mrs. Elizabeth Jordan-Nelson**

10158 Omeara Dr. , Sacramento, CA 95829

**1:00 PM**

STEWARDS: Ms. Mari-Beth O'Neill

**Junior Showmanship Competition**

20 Limited Junior Showmanship Preliminaries #1 (See page 19 )

20 Total Dogs

**RING FIVE**

**JUDGE: Mr. George Milutinovich**

7564 N. Tahan Ave. , Fresno, CA 93711

**2:15 PM**

STEWARDS: Mrs. Dorothy N. Collier, Hon. David C. Merriam & Mr. Dennis Sprung

3 Finnish Spitz 3-0

21 Boston Terriers 14-7

108 Total Dogs

**RING FIVE**

**JUDGE: Ms. Sheree W. Moses**

P.O. Box 448 , Wardensville, WV 26851

**3:15 PM**

STEWARDS: Mrs. Dorothy N. Collier, Hon. David C. Merriam & Mr. Dennis Sprung

10 \*Icelandic Sheepdogs 7-3

5 \*Norwegian Buhunds 3-2

9 Old English Sheepdogs 5-4

88 Total Dogs

**RING SIX**

**JUDGE: Mr. Johan Becerra-Hernandez**

16 Riverside Blvd. Urb. Carmen Hills, San Juan, PR 00926

**9:00 AM**

STEWARDS: Ms. Mary Miller, Mr. Philip M. Bogdanovich & Mr. Ed Hershey II

10 Xoloitzcuintli 4-6

8 Shiba Inu 7-1

**9:45 AM**

18 Tibetan Terriers 9-9

**10:30 AM**

4 Lowchen 3-1

8 Chow Chows 5-3

14 Bichons Frises 10-4

See Ring 5 at 11:45 AM for continuation of assignment.



**RING SIX**

**JUDGE: Mr. David J. Kirkland**

387 Holly Brook Rd. , Sanford, NC 27330

**11:45 AM**

STEWARDS: Ms. Mary Miller, Mr. Philip M. Bogdanovich & Mr. Ed Hershey II  
27 French Bulldogs 18-9

89 Total Dogs

**RING SIX**

**JUDGE: Ms. Jennifer Reed**

P.O. Box 222036, Carmel, CA 93922

**1:00 PM**

STEWARDS: Ms. Mari-Beth O'Neill

**Junior Showmanship Competition**

20 Limited Junior Showmanship Preliminaries #2 (See page 19)

20 Total Dogs

**RING SIX**

**JUDGE: Mr. Johan Becerra-Hernandez**

16 Riverside Blvd. Urb. Carmen Hills, San Juan, PR 00926

**2:15 PM**

STEWARDS: Mrs. Michelle Conroy, Mr. James Conroy & Mr. Al Ferruggiaro

16 German Shepherd Dogs 10-6

102 Total Dogs

**RING SIX**

**JUDGE: Mr. Sei-Ichiro Ishimaru**

2-5-7 Seijo Setagaya-Ku Tokyo, Jpn 1570066

**3:00 PM**

STEWARDS: Mrs. Michelle Conroy, Mr. James Conroy & Mr. Al Ferruggiaro

8 English Toy Spaniels (KC & R) 7-1

13 Japanese Chin 9-4

8 Shih Tzu 2-6

123 Total Dogs

**RING SEVEN**

**JUDGE: Mr. Sei-Ichiro Ishimaru**

2-5-7 Seijo Setagaya-Ku Tokyo, Jpn 1570066

**9:00 AM**

STEWARDS: Ms. Carol Reisman, Ms. Honi Reisman & Ms. Francine Reisman

25 Italian Greyhounds 14-11

**10:00 AM**

8 Manchester Terriers (Toy) 6-2

16 Brussels Griffons 10-6

**11:00 AM**

23 Havanese 13-10

**12:00 NOON**

2 English Toy Spaniels (B & PC) 2-0

20 Chinese Cresteds 12-8

See Ring 6 at 3:00 PM for balance of assignment.

**RING SEVEN**

**JUDGE: Miss Evalyn Gregory**

607 Locust Creek Blvd. , Louisville, KY 40245

**1:00 PM**

STEWARDS: Ms. Christine Erickson, Mrs. Merry Jeanne Millner & Mr. Thomas L. Millner  
33 Cavalier King Charles Spaniels 25-8

**2:15 PM**

6 Tibetan Spaniels 4-2  
17 Dalmatians 8-9

**3:15 PM**

7 Toy Fox Terriers 4-3  
7 Affenpinschers 4-3  
11 Miniature Pinschers 6-5

**4:15 PM**

4 Maltese 2-2  
8 Lhasa Apsos 5-3  
93 Total Dogs

**RING EIGHT**

**JUDGE: Mr. George Milutinovich**

7564 N. Tahan Ave. , Fresno, CA 93711

**9:00 AM**

STEWARDS: Mrs. Henrietta S. Lachman & Mr. Robert Lachman  
32 Pugs 21-11

**10:15 AM**

14 Chihuahuas (Smooth Coat) 8-6  
10 Biewer Terriers 5-5

**11:15 AM**

15 Chihuahuas (Long Coat) 10-5  
3 Silky Terriers 3-0  
10 Yorkshire Terriers 8-2

See Ring 5 at 2:15 PM for balance of assignment.

**RING EIGHT**

**JUDGE: Mrs. Molly Martin**

9355 Vaughn Rd. , Pike Road, AL 36064

**12:30 PM**

STEWARDS: Mr. Jeffrey Pepper, Ms. Rita Holloway & Mr. Douglas Holloway, Jr.  
9 Schipperkes 4-5  
9 Keeshonden 8-1  
7 Cotons de Tulear 4-3

**1:30 PM**

8 Chinese Shar-Pei 2-6  
10 American Eskimo Dogs 4-6  
43 Total Dogs

**RING EIGHT**

**JUDGE: Mr. Glen Lajeski**

32000 Pine Mountain Rd. , Cloverdale, CA 95425

**2:15 PM**

STEWARDS: Mr. Jeffrey Pepper, Ms. Rita Holloway & Mr. Douglas Holloway, Jr.  
9 Pekingese 4-5  
15 Papillons 11-4

**3:15 PM**

10 Poodles (Toy) 5-5  
13 Pomeranians 11-2

**4:15 PM**

8 Poodles (Miniature) 3-5  
16 Poodles (Standard) 12-4  
71 Total Dogs

**Junior Showmanship  
Junior Showmanship Preliminaries  
RINGS 5 & 6**

**RING 5**

**JUDGE: Mrs. Elizabeth Jordan-Nelson**

910158 Omeara Dr., Sacramento, CA 95829

**1:00 PM**

STEWARD: Ms. Mari-Beth O'Neill

Junior Showmanship Preliminaries #1

Nos. 7 9 21 (32) (43) 45 46 (49) 52 55 63 66 67 70 74 75  
76 (78) 81 86

Judge will select 2 Finalists

**RING SIX**

**Ms. Jennifer Reed**

P.O. Box 222036, Carmel, CA 93922

**1:00 PM**

STEWARD: Ms. Mari-Beth O'Neill

Junior Showmanship Preliminaries #2

Nos. 8 10 12 16 23 25 (29) 31 39 53 62 69 71 72 77 79  
80 82 83 84

Judge will select 2 Finalists

**GROUP JUDGING**

Judging of Variety Groups begins at 7:30 PM

**HOUND GROUP**

**Judge: Mr. Jamie Hubbard**

2551 S. Smith Rd., Bloomington, IN 47401

STEWARDS: Mr. William M. Jackson & Mr. T. William Roberts III

**TOY GROUP**

**Judge: Mrs. June A. Penta**

200 Lakeside Way, Greensburg, PA 15601

STEWARDS: Mr. Edwin M. Hershey II & Mr. Harvey M. Wooding

**NON-SPORTING GROUP**

**Judge: Mr. Dennis McCoy**

8537 Smith Rd., Apex, NC 27539

STEWARDS: Dr. Steven Bedford & Mr. Robert A. Engel

HONORARY STEWARD: Mr. James F. Stebbins

**HERDING GROUP**

**Judge: Mr. William (Bill) P. Shelton**

165 E. Columbia Ave., Coventry Cottage, Pomona, CA 91767

STEWARDS: Mrs. Dorothy N. Collier & Mr. Thomas L. Millner

---

---

**SUNDAY, JUNE 13, 2021**

---

---

ENTRY	BREED	RING	TIME
9	Airedale Terriers	5	1:30
7	Akitas	2	10:00
8	Alaskan Malamutes	2	11:00
10	American Hairless Terriers	7	10:00
10	American Staffordshire Terriers	5	2:45
4	Anatolian Shepherd Dogs	2	10:00
10	Australian Terriers	7	10:00
6	Barbets	3	10:30
6	Bedlington Terriers	7	11:00
32	Bernese Mountain Dogs	4	10:15
15	Black Russian Terriers	2	3:15
6	Boerboels	2	2:15
20	Border Terriers	6	3:15
14	Boxers	6	1:00
19	Brittany	3	11:30
3	Bull Terriers (Colored)	5	12:30
1	Bull Terriers (White)	5	12:30
21	Bullmastiffs	8	12:30
18	Cairn Terriers	7	11:00
18	Cane Corsos	2	11:00
8	Cesky Terriers	7	2:00
4	Dandie Dinmont Terriers	7	2:45
29	Doberman Pinschers	4	2:15
13	Dogo Argentinos	4	9:00
13	Dogues de Bordeaux	2	2:15
12	Fox Terriers (Smooth)	5	12:30
10	Fox Terriers (Wire)	5	1:30
3	German Pinschers	8	12:30
11	Giant Schnauzers	6	12:15
5	Glen of Imaal Terriers	7	2:00
23	Great Danes	8	1:30
15	Great Pyrenees	2	10:00
23	Greater Swiss Mountain Dogs	2	1:00
4	Irish Terriers	7	10:00
19	Junior Showmanship Competition Prelim #1	3	1:00
20	Junior Showmanship Competition Prelim #2	7	12:45
15	Kerry Blue Terriers	6	2:00
4	Komondorok	2	3:15
3	Kuvaszok	2	3:15
4	Lagotti Romagnoli	3	11:30
7	Lakeland Terriers	6	11:15
18	Leonbergers	2	9:00
7	Manchester Terriers (Standard)	7	9:00
8	Mastiffs	8	1:30
9	Miniature Bull Terriers	7	9:00
18	Miniature Schnauzers	4	12:15
9	Neapolitan Mastiffs	2	3:15
8	Nederlandse Kooikerhondjes	3	3:30
19	Newfoundlands	4	9:00
7	Norfolk Terriers	7	2:45
11	Norwich Terriers	7	2:45
25	MASTERS OBEDIENCE	9	9:00
8	Parson Russell Terriers	5	1:30
17	Pointers	3	10:30
35	Pointers (German Shorthaired)	1	12:30
7	Pointers (German Wirehaired)	1	2:00
24	Portuguese Water Dogs	1	10:00
9	Rat Terriers	5	12:30
16	Retrievers (Chesapeake Bay)	6	11:15
8	Retrievers (Curly-Coated)	6	9:00
21	Retrievers (Flat-Coated)	6	9:00
44	Retrievers (Golden)	5	9:00
41	Retrievers (Labrador)	5	10:45

ENTRY	BREED	RING	TIME
19	Ret (Nova Scotia Duck Tolling)	6	10:15
21	Rottweilers	1	11:00
10	Russell Terriers	5	3:45
3	Saint Bernards	2	1:00
20	Samoyeds	4	3:30
15	Scottish Terriers	5	2:45
5	Sealyham Terriers	5	3:45
21	Setters (English)	8	3:00
11	Setters (Gordon)	1	3:15
4	Setters (Irish Red and White)	1	2:00
15	Setters (Irish)	1	2:00
25	Siberian Huskies	1	9:00
4	Skye Terriers	7	2:00
14	Soft Coated Wheaten Terriers	6	2:00
4	Spaniels (American Water)	8	10:00
5	Spaniels (Boykin)	8	10:00
9	Spaniels (Clumber)	8	10:00
9	Spaniels (Cocker) A.S.C.O.B.	8	9:00
10	Spaniels (Cocker) Black	1	3:15
5	Spaniels (Cocker) Parti-Color	8	10:00
14	Spaniels (English Cocker)	8	3:00
18	Spaniels (English Springer)	8	11:00
10	Spaniels (Field)	8	9:00
4	Spaniels (Irish Water)	8	9:00
7	Spaniels (Sussex)	8	11:00
5	Spaniels (Welsh Springer)	8	11:00
5	Spinoni Italiani	6	10:15
8	Staffordshire Bull Terriers	7	9:00
15	Standard Schnauzers	4	12:15
7	Tibetan Mastiffs	2	9:00
36	Vizslas	3	9:00
18	Weimaraners	3	2:30
9	Welsh Terriers	7	2:45
13	West Highland White Terriers	5	3:45
9	Wirehaired Pointing Griffons	3	3:30
5	Wirehaired Vizslas	3	2:30

## SUNDAY, JUNE 13, 2021

### RING ONE

**JUDGE: Ms. Kimberly Anne Meredith**

5315 Averill Dr. , Grants Pass, OR 97526

**9:00 AM**

STEWARDS: Mr. Eddie Dziuk & Mr. Al Ferruggiaro

25 Siberian Huskies 11-14

**10:00 AM**

24 Portuguese Water Dogs 16-8

**11:00 AM**

21 Rottweilers 17-4

70 Total Dogs

**RING ONE**

**JUDGE: Mr. Mark E. Threlfall**

637 Daniel Webster Hwy. , Merrimack, NH 03054

**12:30 PM**

STEWARDS: Mrs. Patricia Boelte, Mr. Peter Pettersen & Mr. Harvey Wooding  
35 Pointers (German Shorthaired) 19-16

**2:00 PM**

4 Setters (Irish Red and White) 2-2  
7 Pointers (German Wirehaired) 2-5  
15 Setters (Irish) 7-8

**3:15 PM**

11 Setters (Gordon) 8-3  
10 Spaniels (Cocker) Black 8-2  
82 Total Dogs

**RING TWO**

**JUDGE: Dr. Elliot L. More**

58 Church St. , Deerfield, NH 03037

**9:00 AM**

STEWARDS: Mr. Jeffrey Pepper & Ms. Karen Rockwell  
7 Tibetan Mastiffs 4-3  
18 Leonbergers 10-8

**10:00 AM**

4 Anatolian Shepherd Dogs 2-2  
7 Akitas 5-2  
15 Great Pyrenees 10-5

**11:00 AM**

8 Alaskan Malamutes 4-4  
18 Cane Corsos 12-6

See 3:15 PM for balance of assignment.

**RING TWO**

**JUDGE: Mrs. Sharon Ann Redmer**

7687 Nollar Rd. , Whitmore Lake, MI 48189

**1:00 PM**

STEWARDS: Mrs. Laura Bedford & Mr. Timothy Catterson  
3 Saint Bernards 3-0  
23 Greater Swiss Mountain Dogs 16-7

**2:15 PM**

6 Boerboels 4-2  
13 Dogues de Bordeaux 4-9  
45 Total Dogs

**RING TWO**

**JUDGE: Dr. Elliot L. More**

58 Church St. , Deerfield, NH 03037

**3:15 PM**

STEWARDS: Mrs. Laura Bedford & Mr. Timothy Catterson  
9 Neapolitan Mastiffs 5-4  
15 Black Russian Terriers 7-8  
3 Kuvaszok 1-2  
4 Komondorok 3-1

108 Total Dogs

**RING THREE**

**JUDGE: Mr. David L. Kittredge**

34 Marlborough Rd. , Rochester, NY 14619

**9:00 AM**

STEWARDS: Mrs. Jan Richie Gladstone, Mrs. Ann J. Yuhasz & Mr. Darrell W. Crate  
36 Vizslas 18-18

**10:30 AM**

6 Barbets 2-4  
17 Pointers 5-12

**11:30 AM**

4 Lagotti Romagnoli 1-3  
19 Brittanys 13-6

See 3:15 PM for balance of assignment.

**RING THREE**

**JUDGE: Mrs. Elizabeth Jordan-Nelson**

10158 Omeara Dr. , Sacramento, CA 95829

**1:00 PM**

STEWARDS: Ms. Mari-Beth O'Neill

**Junior Showmanship Competition**

19 Limited Junior Showmanship Preliminaries #1 (See page 27)  
19 Total Dogs

**RING THREE**

**JUDGE: Mr. David L. Kittredge**

34 Marlborough Rd. , Rochester, NY 14619

**2:30 PM**

STEWARDS: Mrs. Polly Smith & Mrs. Gayle Bontecou

5 Wirehaired Vizslas 5-0  
18 Weimaraners 8-10

**3:30 PM**

9 Wirehaired Pointing Griffons 4-5  
8 Nederlandse Kooikerhondjes 3-5

122 Total Dogs

**RING FOUR**

**JUDGE: Mr. Johan Becerra-Hernandez**

16 Riverside Blvd. Urb. Carmen Hills, San Juan, PR 00926

**9:00 AM**

STEWARDS: Mrs. Susan Sprung & Ms. Viola Burgos

19 Newfoundlands 15-4  
13 Dogo Argentinos 7-6

**10:15 AM**

32 Bernese Mountain Dogs 23-9

See 2:15 PM for balance of assignment.

**RING FOUR**

**JUDGE: Mr. David J. Kirkland**

387 Holly Brook Rd. , Sanford, NC 27330

**12:15 PM**

STEWARDS: Ms. Elaine Lessig & Mr. Milan Lint

11 Giant Schnauzers 6-5  
15 Standard Schnauzers 8-7  
18 Miniature Schnauzers 12-6

44 Total Dogs

**RING FOUR**

**JUDGE: Mr. Johan Becerra-Hernandez**

16 Riverside Blvd. Urb. Carmen Hills, San Juan, PR 00926

**2:15 PM**

STEWARDS: Ms. Elaine Lessig & Mr. Milan Lint  
29 Doberman Pinschers 16-13

**3:30 PM**

20 Samoyeds 12-8

113 Total Dogs

**RING FIVE**

**JUDGE: Ms. Marjorie Martorella**

31 Roberts Rd. , Millstone Township, NJ 08535

**9:00 AM**

STEWARDS: Mrs. Rita Holloway, Mr. Douglas Holloway, Jr. & Dr. Niska Lemo  
44 Retrievers (Golden) 26-18

**10:45 AM**

41 Retrievers (Labrador) 22-19

See Ring 8 at 3:00 PM for balance of assignment.

**RING FIVE**

**JUDGE: Ms. Patricia Anne Keenan**

3080B Jackson Hwy. , Chehalis, WA 98532

**12:30 PM**

STEWARDS: Ms. Debra Gschwender, Mr. Rick Gschwender & Mr. Johnston L. Evans

3 Bull Terriers (Colored) 1-2

1 Bull Terriers (White) 0-1

12 Fox Terriers (Smooth) 8-4

9 Rat Terriers 5-4

**1:30 PM**

8 Parson Russell Terriers 7-1

9 Airedale Terriers 6-3

10 Fox Terriers (Wire) 7-3

**2:45 PM**

10 American Staffordshire Terriers 6-4

15 Scottish Terriers 8-7

**3:45 PM**

13 West Highland White Terriers 8-5

10 Russell Terriers 7-3

5 Sealyham Terriers 4-1

105 Total Dogs

**RING SIX**

**JUDGE: Ms. Bonnie P. Threlfall**

105 Tayport Ct. , Cary, NC 27511

**9:00 AM**

STEWARDS: Mrs. Henrietta S. Lachman & Mr. Robert Lachman

8 Retrievers (Curly-Coated) 5-3

21 Retrievers (Flat-Coated) 13-8

**10:15 AM**

5 Spinoni Italiani 2-3

19 Ret (Nova Scotia Duck Tolling) 13-6

**11:15 AM**

7 Lakeland Terriers 2-5

16 Retrievers (Chesapeake Bay) 10-6

See 2:00 PM for balance of assignment.



**RING SIX**

**JUDGE: Miss Evalyn Gregory**

607 Locust Creek Blvd. , Louisville, KY 40245

**1:00 PM**

STEWARDS: Mr. Edwin M. Hershey II, Ms. Christine Erickson & Ms. Teresa Hundt

14 Boxers 9-5

14 Total Dogs

**RING SIX**

**JUDGE: Ms. Bonnie P. Threlfall**

105 Tayport Ct. , Cary, NC 27511

**2:00 PM**

STEWARDS: Mr. Edwin M. Hershey II, Ms. Christine Erickson & Ms. Teresa Hundt

14 Soft Coated Wheaten Terriers 6-8

15 Kerry Blue Terriers 9-6

**3:15 PM**

20 Border Terriers 13-7

125 Total Dogs

**RING SEVEN**

**JUDGE: Mrs. Knowlton A. Reynders**

120 Morse Hill Rd. , Newbury, NH 03255

**9:00 AM**

STEWARDS: Mrs. Barbara A. Pessina & Mr. Ian Gabriel

8 Staffordshire Bull Terriers 6-2

9 Miniature Bull Terriers 4-5

7 Manchester Terriers (Standard) 3-4

**10:00 AM**

10 Australian Terriers 6-4

10 American Hairless Terriers 7-3

4 Irish Terriers 3-1

**11:00 AM**

6 Bedlington Terriers 3-3

18 Cairn Terriers 11-7

See 2:00 PM for balance of assignment.

**RING SEVEN**

**JUDGE: Ms. Jennifer Reed**

P.O. Box 222036, Carmel, CA 93922

**12:45 PM**

STEWARDS: Ms. Mari-Beth O'Neill

**Junior Showmanship Competition**

20 Limited Junior Showmanship Preliminaries #2 (See page 27)

20 Total Dogs

**RING SEVEN**

**JUDGE: Mrs. Knowlton A. Reynders**

120 Morse Hill Rd. , Newbury, NH 03255

**2:00 PM**

STEWARDS: Mrs. Barbara A. Pessina & Ms. Mary A. Miller

4 Skye Terriers 4-0

5 Glen of Imaal Terriers 5-0

8 Cesky Terriers 4-4

**2:45 PM**

7 Norfolk Terriers 4-3

9 Welsh Terriers 6-3

11 Norwich Terriers 11-0

4 Dandie Dinmont Terriers 4-0

120 Total Dogs

**RING EIGHT**

**JUDGE: Mr. Michael Faulkner**

P.O. Box 208 , Center Cross, VA 22437

**9:00 AM**

STEWARDS: Mr. Harvey M. Wooding & Mrs. Sandra McCue

- 4 Spaniels (Irish Water) 2-2
- 10 Spaniels (Field) 8-2
- 9 Spaniels (Cocker) A.S.C.O.B. 7-2

**10:00 AM**

- 9 Spaniels (Clumber) 9-0
- 4 Spaniels (American Water) 3-1
- 5 Spaniels (Boykin) 3-2
- 5 Spaniels (Cocker) Parti-Color 5-0

**11:00 AM**

- 5 Spaniels (Welsh Springer) 2-3
- 7 Spaniels (Sussex) 5-2
- 18 Spaniels (English Springer) 11-7

76 Total Dogs

**RING EIGHT**

**JUDGE: Mr. Glen Lajeski**

32000 Pine Mountain Rd. , Cloverdale, CA 95425

**12:30 PM**

STEWARDS: Mrs. Dorothy N. Collier, Mrs. Michelle Conroy & Mr. James Conroy

- 3 German Pinschers 3-0
- 21 Bullmastiffs 11-10

**1:30 PM**

- 8 Mastiffs 5-3
- 23 Great Danes 12-11

55 Total Dogs

**RING EIGHT**

**JUDGE: Ms. Marjorie Martorella**

31 Roberts Rd. , Millstone Township, NJ 08535

**3:00 PM**

STEWARDS: Mrs. Dorothy N. Collier, Mrs. Michelle Conroy & Mr. James Conroy

- 14 Spaniels (English Cocker) 11-3
- 21 Setters (English) 12-9

120 Total Dogs

**RING NINE**

**JUDGE: Mrs. Louise Botko**

4516 Vincent Ave. S., Minneapolis, MN 55410

**9:00 AM**

STEWARDS: Ms. Janet Doerer, Ms. Linda S. Brennan, Ms. Kathleen Keller & Ms. Kathleen Walker

- 25 Utility Class B Obedience Entries  
Nos 5 6 7 8 9 10 11 12 14 15 16 17 18 19 20 21 22 23 24 25 26  
27 28 29 30
- 25 Open Class B Obedience Entries  
Nos 5 6 7 8 9 10 11 12 14 15 16 17 18 19 20 21 22 23 24 25 26  
27 28 29 30

**Junior Showmanship  
Junior Showmanship Preliminaries  
RING 3 & 7**

**RING THREE**

**JUDGE: Mrs. Elizabeth Jordan-Nelson**

10158 Omeara Dr., Sacramento, CA 95829

**1:00 PM**

**STEWARDS:** Ms. Mari-Beth O'Neill

Junior Showmanship Preliminaries #1

Nos. 6 15 17 18 (22) (24) 26 33 41 42 44 54 (57) 59 (60)  
65 (68) 73 85

Judge will select 2 Finalists

**RING SEVEN**

**JUDGE: Ms. Jennifer Reed**

P.O. Box 222036, Carmel, CA 93922

**1:00 PM**

**STEWARDS:** Ms. Mari-Beth O'Neill

Junior Showmanship Preliminaries #2

Nos. 11 (19) 20 27 28 30 34 35 (36) 37 38 40 (47) 48 (50)  
51 56 58 61 64

Judge will select 2 Finalists

**GROUP RING**

**7:00 PM**

**Junior Showmanship Finals**

**JUDGE: \*Ms. Dylan Kipp-Keith**

6915 Cedar Run Cir., Spring TX 77379

**STEWARDS:** Mr. David W. Haddock & Mr. Charlton Reynders III

**VARIETY GROUPS & BEST IN SHOW JUDGING**

Judging of Variety Groups begins at 7:30 PM

**SPORTING GROUP**

**Judge: Mr. James S. Covey**

22 Red Barn Dr., Ballston Lake, NY 12019

**STEWARDS:** Mr. Darrell W. Crate & Mr. Benjamin Saunders

**WORKING GROUP**

**Judge: Ms. Judy A. Harrington**

20 Pinnacle Rd., Rt. 1, Monson, MA 01057

**STEWARDS:** Mr. F. Avery Bourke & Hon. James G. Phinizy

**TERRIER GROUP**

**Judge: Mr. William F. Potter**

721 Plantmore Dr., Saint Louis, MO 63135

**STEWARDS:** Mr. Philip M. Bogdanovitch & Mr. Johnston L. Evans

**BEST IN SHOW**

**Judge: Mrs. Patricia V. Trotter**

P.O. Box 222036, Carmel, CA 93922

**STEWARDS:** Mr. David W. Haddock, Mr. David A. Helming  
& Mr. Charlton Reynders III

# **RULES AND PROCEDURES**

## **EXHIBITOR TICKET INFORMATION**

**NOTICE:** Groups and Best in Show seating will be VERY limited. Exhibitors, who remain on site, will be able to view the finals from monitors in an auxiliary tent as New York State COVID-19 compliance guidelines and restrictions allow.

After working closely with New York State officials regarding COVID-19 attendance restrictions for the 2021 dog show, the club will include two (2) exhibitor tickets per entered dog for daytime competition only, on the day the dog is exhibited. These passes will be part of each dog's entry packet. Owners of Best of Breed winners should go to the Superintendent's Office for information on attending the evening Group competition.

1. **DO NOT BRING ANY DOGS THAT ARE NOT ENTERED.** There is no provision for unentered dogs at this show. See also **Premium List pages 2, 9, 27, 31, 38.**
2. All regular exhibitor tickets, dog ID's, etc., are sent to the address noted on the entry form. Owners or the owners' duly authorized agent are responsible for the correctness. **No duplicate packets are mailed.** See **Premium List** page 12 regarding the Foreign Mail Option.
3. Regular exhibitor ticket packets returned by the Post Office marked "Undeliverable" are held at the show in the Superintendent's Office.
4. **NOTE: Juniors will receive a separate admission pass for all show days, two guardian tickets are also included. Misuse of this Junior Pass could result in an Event Committee hearing, removal from the show and/or exclusion from future competition at this show.**

## **PARKING**

To respect and preserve the historic grounds of the Lyndhurst Estate, RVs are not allowed on the grounds. Parking at the show will be limited to (Non-RV) vehicles (without trailers) not to exceed 30 feet (ALL INCLUSIVE) in total length. Exhibitor setups may be left on site Saturday overnight, but vehicles and dogs will need to be removed in compliance with municipal ordinances. **PERSONAL GOLF CARTS NOT ALLOWED ON SITE.** Please see the Westminster website for outside parking options and follow the directions of the Village of Tarrytown Police, Site Control and Security upon arrival to the show grounds.

1. There is NO overnight parking or accommodations.
2. Each Exhibitor packet will include a hangtag for Exhibitor parking in a lot on the Show Site. This hangtag is good for the day your dog is being shown ONLY. Due to COVID 19, a "Show and Go" policy is in place.

## JUDGING

1. The conformation judging starts promptly; no exception for tardiness. During the hours of judging exhibitors are to be on call and have their dogs ready to bring into the ring promptly.
2. The owner of the dog or the handler is responsible for the presence of their dog in the judging ring. There is no rule of this Club or the American Kennel Club that requires a judge to wait for an owner or handler to bring his dog into the ring.
3. **WRISTBANDS:** Exhibitor Wristbands will be given out each day as a part of our COVID-19 protocol and must be worn throughout the day on your left wrist.
4. **All cell phones, pagers, beepers, etc. must be on “mute” or “vibrate” when in or near the ring area. Persons with ringing or toning cell phones, pagers, beepers, etc. will be escorted from the ring area. No cell phone photos/videos are permitted.**
5. A judge requesting the use of a ramp must give notice to the show superintendent/show secretary prior to judging. AKC approval is not required.

The entire entry in a breed is to be examined in the same manner (ground, table, or ramp).

At the discretion of the judge, the following breeds may be judged on the ground or on a ramp through all levels of competition including Group and Best in Show judging: Lagotti Romagnoli, Nova Scotia Duck Tolling Retrievers, American Water Spaniels, English Springer Spaniels, Field Spaniels, Welsh Springer Spaniels, Grand Basset Griffon Vendeens, Standard Schnauzers, American Staffordshire Terriers, Irish Terriers, Kerry Blue Terriers, Soft Coated Wheaten Terriers, Staffordshire Bull Terriers, Finnish Spitz, Entlebucher Mountain Dogs, Finnish Lapphunds, Icelandic Sheepdogs, Norwegian Buhunds, Polish Lowland Sheepdogs, Spanish Water Dogs and Norrbottenspets (Misc.).

At the discretion of the judge, the following breed may be judged on a table or on a ramp through all levels of competition including Group and Best in Show judging: Mudik (Misc.).

At the discretion of the judge through all levels of competition including Group and Best in Show judging, the following breeds may be judged on the ground, a ramp, or on a table: Boykin Spaniels, Whippets & Miniature Bull Terriers.

The following breeds must be judged on a ramp through all levels of conformation competition: Clumber Spaniels, Sussex Spaniels, Basset Hounds, Cirnechi dell'Etna, Bulldogs, Chinese Shar-Pei, Chow Chows and Keeshonden. This extends to all conformation competition at AKC conformation dog shows and any AKC event where a conformation title may be earned. This policy includes Group, BIS, Junior Showmanship, the 4-6 Month Beginner Puppy Competition, the AKC National Owner-Handled Series (NOHS), and all other special attractions that offer Group and BIS competitions.

Ramps can be used in emergency situations to judge any breed. In an emergency situation, where use of a ramp is not indicated in the premium list, an exhibitor has the option of withdrawing their entry and receiving a refund.

For the judging of juniors the ramp may be used at the discretion of the judge for the ramp optional breeds.

## **LOSS OR DAMAGE**

1. The WKC, the Superintendent and site management will not be responsible for the loss or damage to any dog or property of any exhibitor, whether the result of accident or any other cause. It is expressly understood that every dog at the show is in the care and custody and control of its owner or handler during the time the dog is on the show premises. See also the Agreement on the reverse of the entry form.
2. The welfare of an exhibitor's/spectator's child is the responsibility of the exhibitor/spectator. It is expressly understood that exhibitors/spectators will exercise control and restraint over their children while they are on the show premises. The use of child strollers is NOT recommended.
3. The Westminster Kennel Club and its Superintendent caution all persons entering the show site and show grounds against all hazards which may exist, including, but not limited to: Condition of the site/grounds, parking/loading/unloading areas, entrances, floors and stairways, floor coverings, walkways, tenting/canopies, electrical appliances, cords and fittings, exercise pens, and the presence of animals. All persons should take into consideration this is a sporting event and dress, act and exercise caution appropriate for the activity involved. All persons entering the show, the grounds, site and show areas for whatever purpose do so entirely at their own risk. By virtue of entering the show, the entrant has indicated their acceptance of the terms listed in this premium list and assumes all risks involved.

4. No entry fees are returned if the show cannot open or be completed by reason of riots, wars, civil disturbances, national emergencies, health emergencies, extreme weather conditions, fire and Act of God, public emergency, act of a public enemy, strikes, and the dictates of law enforcement or of the owner(s) of the grounds and/or facilities or any other cause beyond the control of The Westminster Kennel Club, nor shall Lyndhurst or the Superintendent be liable in any way. The well-being of dogs, exhibitors and spectators is of paramount importance and in the event it is necessary to cancel or stop the show before completion, no refund of entry fee will be made. To find out about any AKC event cancellations call the AKC Event Cancellation Hotline (877) 252-3229.

## **EQUIPMENT**

1. By entering this show, exhibitors and handlers agree to follow all directions of the special assistants charged with arranging and maintaining orderly conditions in the grooming areas. Abuse of these assistants will not be tolerated.
2. **Grooming will take place at the exhibitor's vehicle or in the grooming tent. Electric dryers are prohibited in the grooming tent. All crates/tack units must be stacked. There is no electric in the grooming tent. Please follow grooming tent and COVID protocol at ALL times. Exhibitors are expected to keep their grooming area clean. Exhibitors who set up in the grooming tent should remove their equipment promptly after exhibiting unless dog is required for Group judging.**
3. **No Flexi/retractable leads or stacking trainer equipment permitted at this show.**
4. **Fabric crates are not permitted at this show.**
5. **Public exercise pens will be for multiple dogs at all times. Dogs must be on lead in exercise pens. No exceptions. A separate area will be provided for bitches in season. Owners/handlers are to clean-up after their dogs. Blocking off exercise pens is NOT permitted.**

**No private exercise pens are permitted within the grooming tent at anytime. Private exercise pens are permitted at vehicle set-ups. Owner/Handlers are solely responsible for clean-up of their private exercise pens.**

6. **For the safety of all, no other tables and other furniture are allowed in the ring areas. No aisle obstruction is permitted.**
7. Handbills, circulars, or other printed matter may not be distributed at this show.
8. No gasoline or diesel powered generators are permitted within 100 feet of any tent in which the show is conducted. All cords must be secured to avoid tripping hazards.
9. Neither WKC, Lyndhurst, nor the Superintendent is responsible for any equipment or supplies or other belongings left on the show site.

## **AGREEMENT**

1. By entering this show, all participants agree to the following: All rights to advertise, promote, publicize, televise or otherwise exploit the show are vested in The Westminster Kennel Club and its assigns, including the use of the names, likenesses, voices or biographical matter of all dogs, owners, handlers, and kennels participating in the show.
2. **By entering, exhibiting or attending this show, all parties associated with the entry acknowledge, accept and agree, to comply at all times with all of the COVID-19 compliance requirements described herein, or as otherwise amended prior to or during the event. See also page 4.**
3. **The Club permits only its credentialed personnel to use any video recording devices for this show.**
4. The Westminster Kennel Club reserves the right to broadcast or cause to be broadcast any or all portions of The Westminster Kennel Club Dog show by any means of known transmission of video material.
5. The use of any Westminster Kennel Club logo, trademark or any other likeness associated with the Westminster Kennel Club is expressly prohibited without the written consent of the club.

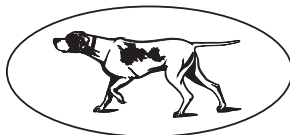



# STEP-BY-STEP DIRECTIONS

**There will be one main entry gate and one exit for the show at Lyndhurst. Please follow the directions of Tarrytown Village Police and Security on site. Travel directions are as follows:**

## **By Car**

### **From Westbound 287**

#### **(from Eastern Westchester/Connecticut):**

Take 287 west/87 North to the last exit before the Mario Cuomo Bridge, exit 9 off the NY State Thruway, marked Route 9 Tarrytown. Take a left onto 119 at the first stoplight and a left (south) onto Route 9 at the second stoplight. The Lyndhurst gates are ½ mile on the right-hand (river) side of the road.

#### **From Eastbound 287 (from Rockland/New Jersey):**

Take 287 east across the Mario Cuomo Bridge. Immediately after the toll booth, take the first exit, Exit 9. Turn left (south) onto Route 9 and proceed ½ mile to the Lyndhurst gates on the right-hand (river) side of the road.

#### **From New York City's East Side:**

Drive north on the East River Drive, across the Willis Avenue Bridge onto the Major Deegan Expressway North. Follow the Deegan to the NY State Thruway (I-87) to Westbound 287 (Mario Cuomo Bridge). Follow westbound 287 directions above.

#### **From New York City's West Side:**

Drive North on the West Side Highway to the Henry Hudson north to the Saw Mill Parkway north to the NY State Thruway (I-87) North to 287 West (Mario Cuomo Bridge). Follow westbound 287 directions above.

#### **From Connecticut:**

Take either I-95, I-684, or the Merritt Parkway South to 287 West (to the Mario Cuomo Bridge). Follow westbound 287 directions above.

#### **From Long Island:**

Take either:

The Whitestone or Throgs Neck Bridge to the New England Thruway (I-95). Take Exit 21 onto 287 West (to the Mario Cuomo Bridge). Follow westbound 287 directions above.

–OR–

The Triboro Bridge to the Major Deegan North and the NY State Thruway (I-87) to 287 West (to the Mario Cuomo Bridge). Follow westbound 287 directions above.

#### **Taxi and other ride services**

Metro North Railroad operates a train from Grand Central to Tarrytown, from which you would take a cab to Lyndhurst. Please notify your Taxi, Lyft, or Uber driver to drop you off at the Lyndhurst Gate. If you are relying on a car service for drop-off and pick-up, consider scheduling in advance as service may be limited.

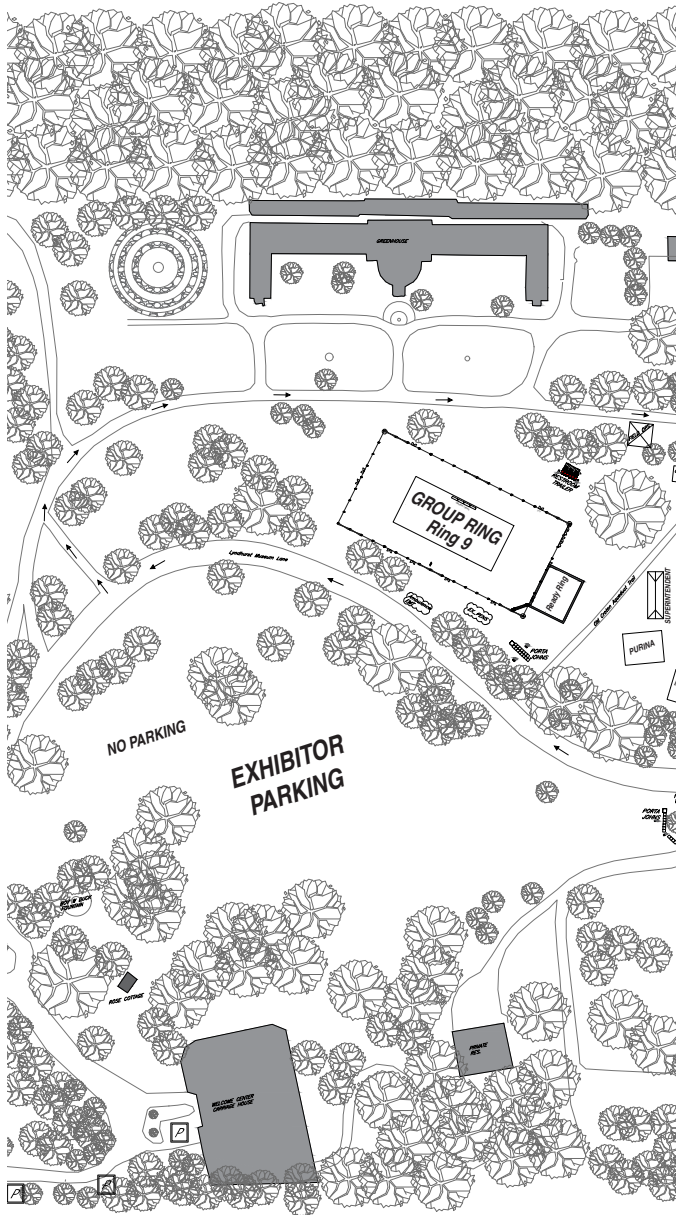

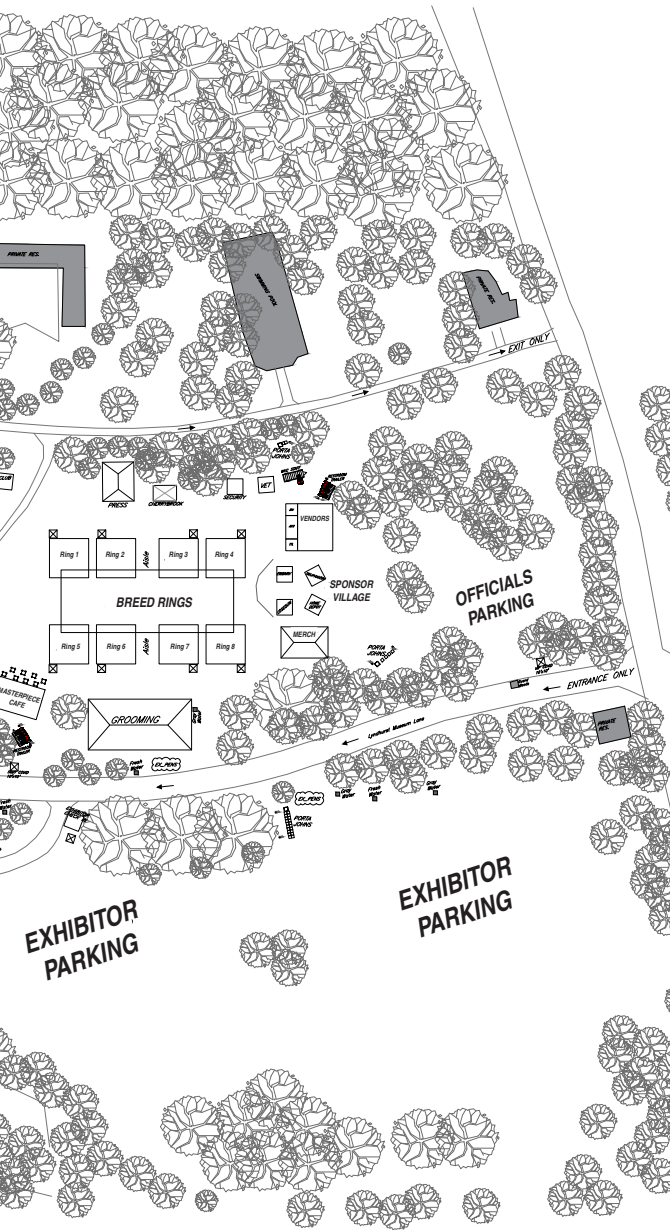



THE 145<sup>TH</sup> ANNUAL

**WESTMINSTER**  
KENNEL CLUB DOG SHOW

PRESENTED BY

